

This step-by-step guide will demonstrate how to create True or False Questions within the **Quizzes** tool in Desire2Learn (D2L).

Quizzes: Create Questions – True or False

1. Select **Quizzes**.



2. Select one of the following two options.
 - a. Select **Question Library** (recommended option).

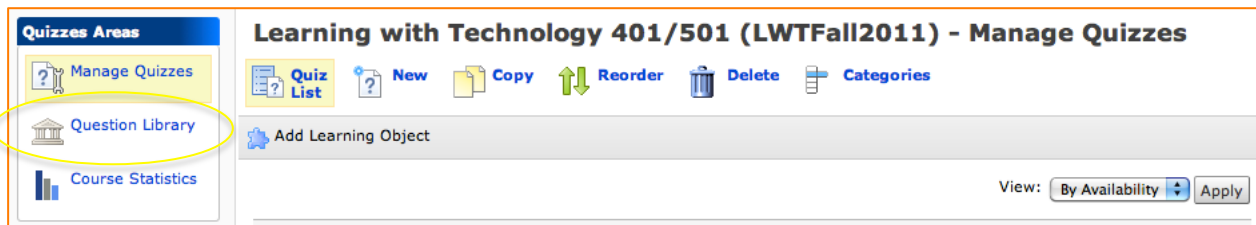

- b. Select the desired quiz.

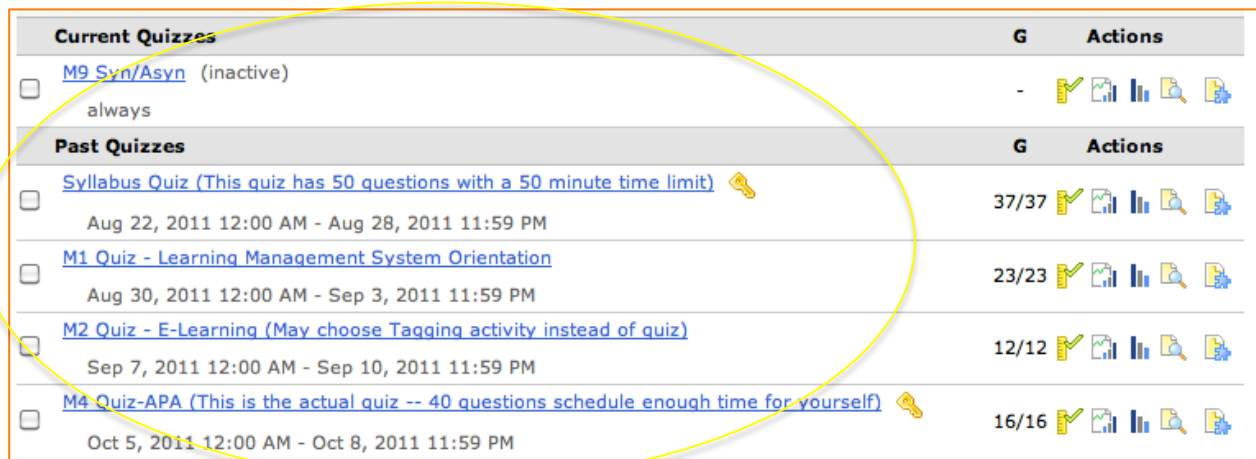

i. Select the **Layout/Questions** tab for that quiz.

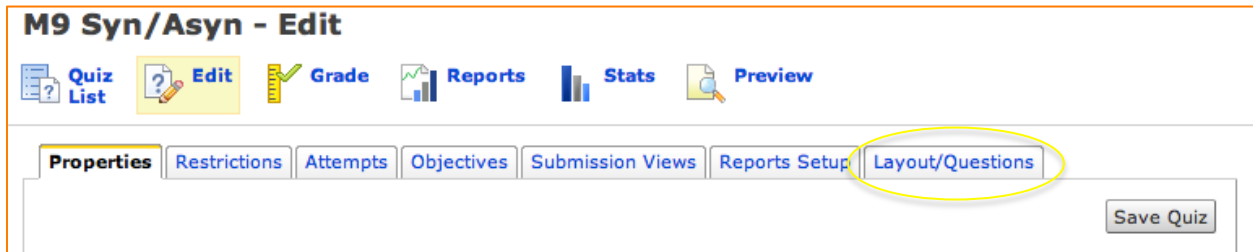

ii. Select **Add/Edit Questions**.

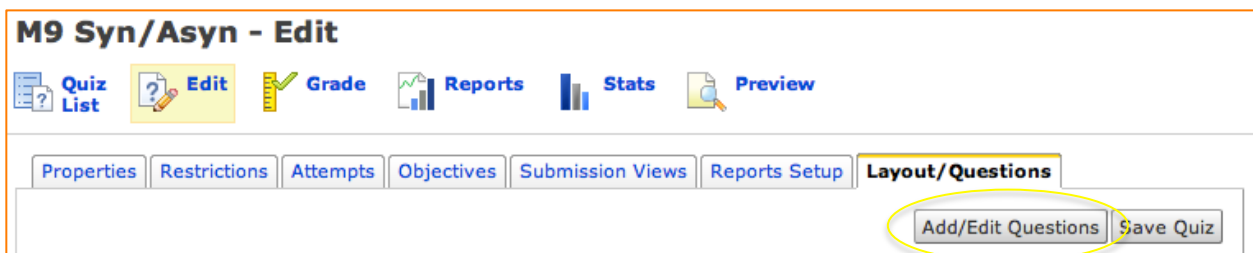

3. *Optional:* Select a **Section** into which the new question(s) will be placed.

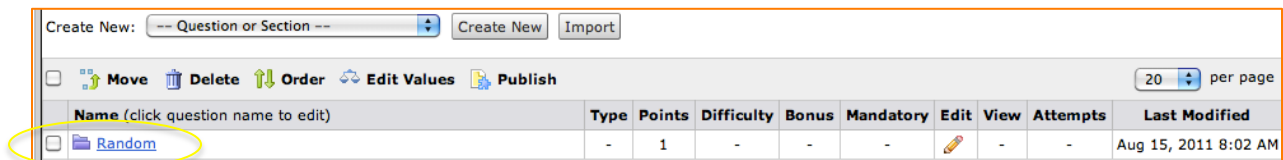

Note: See step-by-step guide *Quizzes: Layout/Questions Tab* on how to create sections.

Warning: Questions or information created within a **Random Section** cannot be copied and will be available only within that specific section.

4. Select **True or False Question (T/F)** from the dropdown menu.

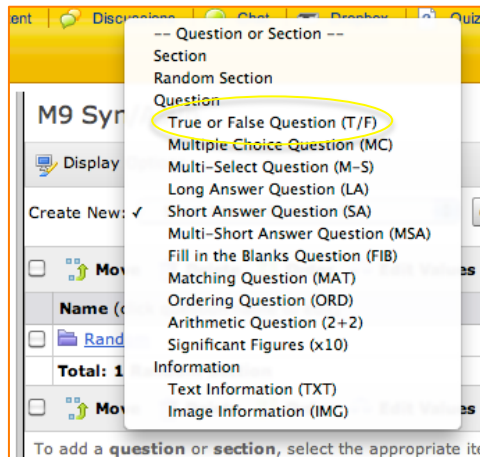

5. Select **Create New**.

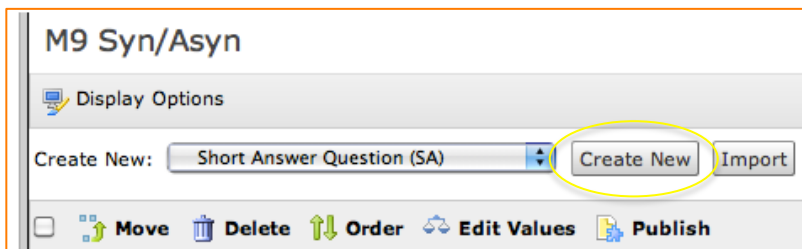

Enter Question Information

6. *Optional*: Enter a **Title**.
7. *Optional*: Edit the number of **Points** the question is worth.
8. *Optional*: Edit the level of **Difficulty**.
9. Enter the **Question Text**.
10. *Optional*: Add an image by selecting **Add a File**.

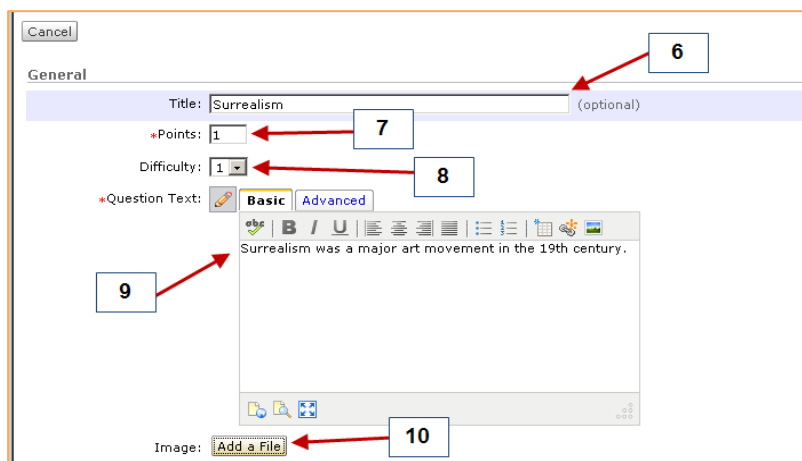

a. *Optional*: Enter a **Description** of the image.



Enter Answer Information

11. *Optional*: Select a type of **Enumeration** from the dropdown menu.

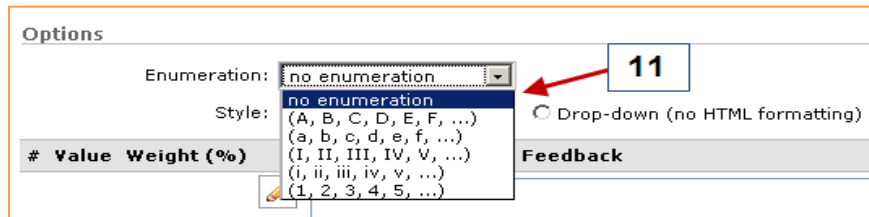

12. *Optional*: Select a presentation **Style**.

13. Enter the weight 100% for the **correct answer**.

14. *Optional*: For the **True** and/or **False** options, enter **Feedback** to be shared when these answers are selected (if enabled).

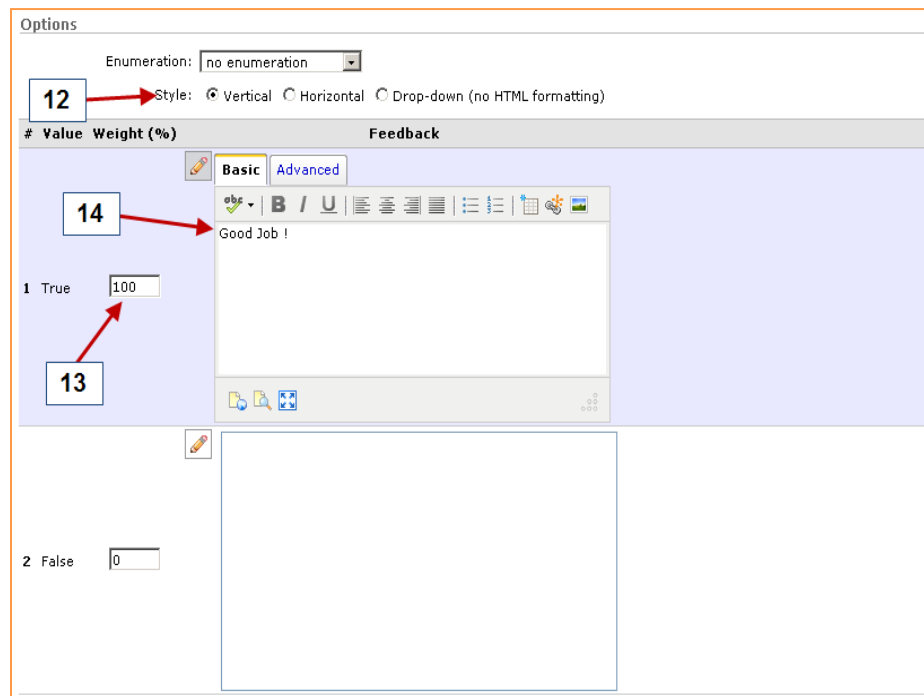

15. *Optional*: Enter a **Question Hint**.

16. *Optional*: Enter **Question Feedback** to display no matter what answer the user selects.

Question Hint: [edit icon]

15 →

Question Feedback: [edit icon]

16 →

Preview and/or Save

17. *Optional:* Select **Preview** to view the question and optional feedback or hint.

Cancel [17] Preview Save Save and Copy Save and New

General

a. Select **Go Back**.

view question

Go Back [17a]

When taking the question, it would appear as:

Surrealism was a major art movement in the 19th century.

True

False

When grading the question, it would appear as:

Surrealism was a major art movement in the 19th century.

True

False

Comment: (given as feedback)

- No comment specified. -

Hint:

- No hint specified. -

18. Select one of the following Save options:
- Select **Save**.
 - Select **Save and Copy** to create a copy that will open immediately for editing.
 - Select **Save and New** to immediately open a new blank question.

The screenshot shows the 'New True or False Question' form. At the top right, there are four buttons: 'Preview', 'Save', 'Save and Copy', and 'Save and New'. Below these buttons, three red arrows point to the 'Save', 'Save and Copy', and 'Save and New' buttons, which are labeled '18a', '18b', and '18c' respectively. The form fields are as follows:

- Cancel** button on the top left.
- Title:** A text input field containing 'Surrealism' with '(optional)' to its right.
- Points:** A numeric input field containing '1'.
- Difficulty:** A dropdown menu showing '1'.
- Question Text:** A text area containing 'Surrealism was a major art movement in the 19th century.'